

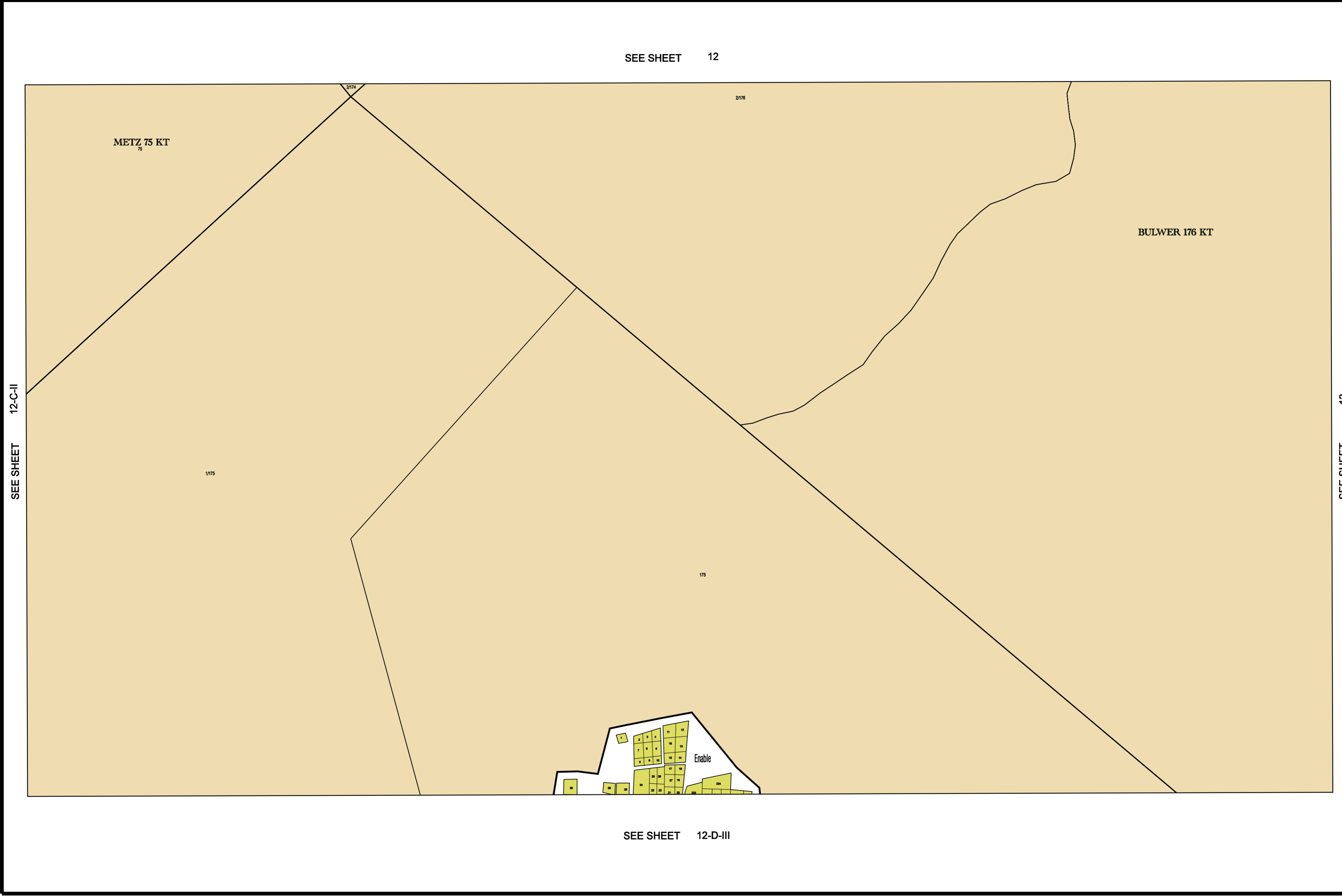

SKAAL - SCALE 1 : 5 000



SEE SHEET 12

SEE SHEET 12-D-III

LAND USE

SEE SHEET 12-C-II

SEE SHEET 12

- VERWYSING - REFERENCE
- SCHEME BOUNDARY
 - TOWNSHIP BOUNDARY
 - ANNEXURE NUMBER
 - PRIVATE ROADS AND RIGHT OF WAY
 - BUILDING LINE
 - LINE OF NO ACCESS
- NOTE:**
The position of all roads (both national and provincial roads) as well as railway lines outside proclaimed townships are approximate and not final.

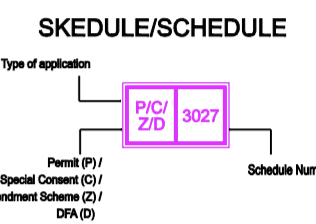

LAND USE

RESIDENTIAL 1 - Use Zone 1	
RESIDENTIAL 1 - Use Zone 2 (Rural Settlement)	
RESIDENTIAL 2 - Use Zone 3	
RESIDENTIAL 3 - Use Zone 4	
RURAL RESIDENTIAL - Use Zone 5	
BUSINESS 1 - Use Zone 6	
BUSINESS 2 - Use Zone 7	
BUSINESS 3 - Use Zone 8	
INDUSTRIAL 1 - Use Zone 9	
INDUSTRIAL 2 - Use Zone 10	
INSTITUTIONAL - Use Zone 11	
EDUCATIONAL - Use Zone 12	
MUNICIPAL - Use Zone 13	
AGRICULTURAL - Use Zone 14	
PUBLIC GARAGE - Use Zone 15	
PUBLIC OPEN SPACE - Use Zone 16	
PRIVATE OPEN SPACE - Use Zone 17	
GOVERNMENT - Use Zone 18	
PROTECTED AREAS - Use Zone 19	
RESORT - Use Zone 20	
MINING 1 & QUARRYING - Use Zone 21	
MINING 2 - Use Zone 22	
EXISTING PUBLIC ROADS - Use Zone 23	
RAIL TRANSPORTATION SERVICES - Use Zone 24	
SPECIAL - Use Zone 25	
AERODROME - Use Zone 26	
INFORMAL ACCESS & OPEN SPACE - Use Zone 27	

RECOMMENDED FOR APPROVAL

MUNICIPAL MANAGER

MARULENG 2008

APPROVED