

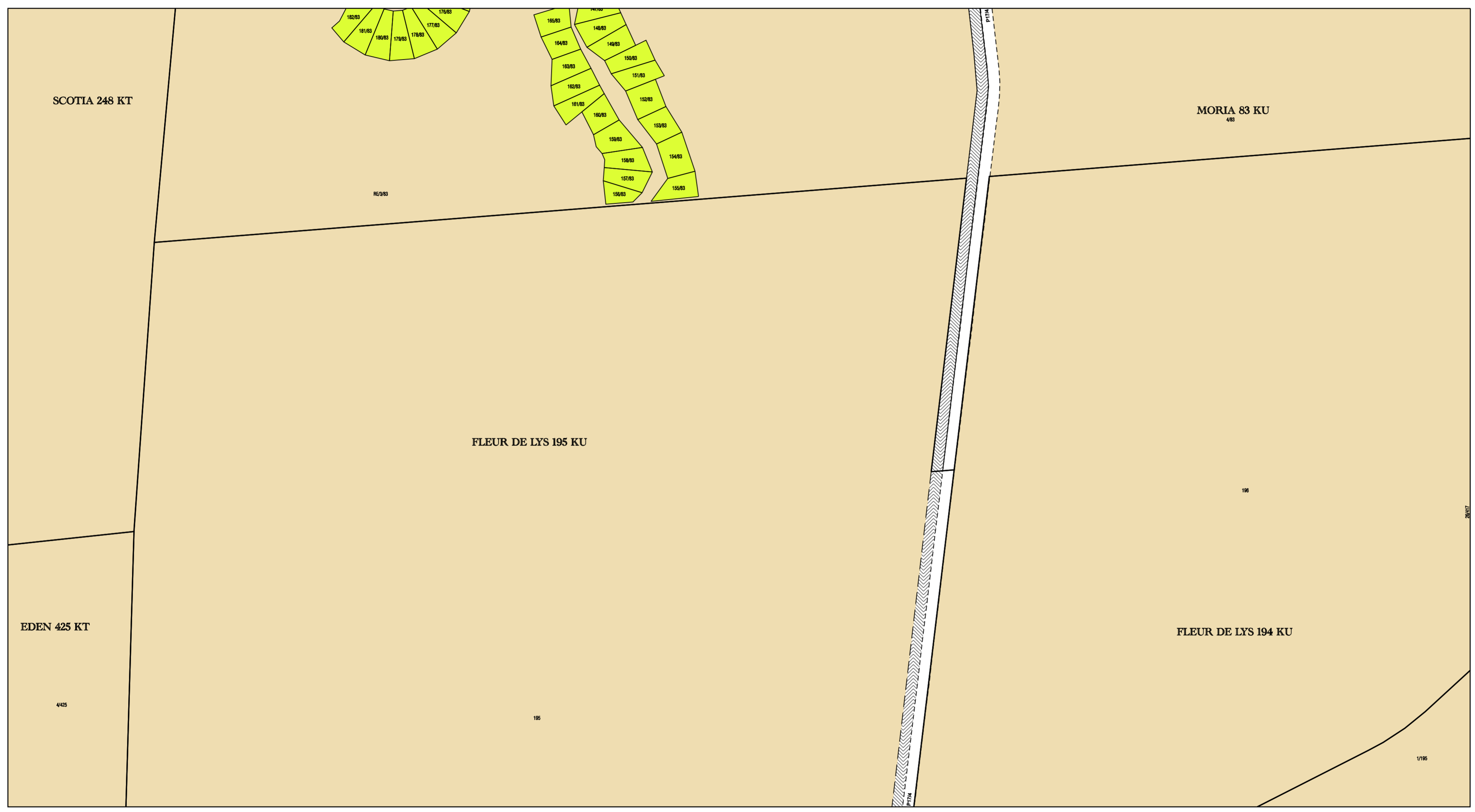

SKAAL - SCALE 1 : 5 000

SEE SHEET 27

SEE SHEET 28



SEE SHEET 25-C-III

SEE SHEET 28-A-III

LAND USE

VERWYSING - REFERENCE

- SCHEME BOUNDARY
- TOWNSHIP BOUNDARY
- ANNEXURE NUMBER
- PRIVATE ROADS AND RIGHT OF WAY
- BUILDING LINE
- LINE OF NO ACCESS

NOTE: The position of all roads (both national and provincial roads) as well as railway lines outside proclaimed townships are approximate and not final.

SKEDULE/SCHEDULE

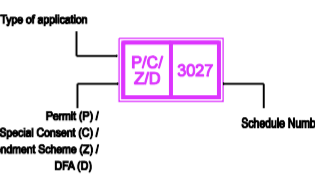

LAND USE

- RESIDENTIAL 1 - Use Zone 1
- RESIDENTIAL 1 - Use Zone 2 (Rural Settlement)
- RESIDENTIAL 2 - Use Zone 3
- RESIDENTIAL 3 - Use Zone 4
- RURAL RESIDENTIAL - Use Zone 5
- BUSINESS 1 - Use Zone 6
- BUSINESS 2 - Use Zone 7
- BUSINESS 3 - Use Zone 8
- INDUSTRIAL 1 - Use Zone 9
- INDUSTRIAL 2 - Use Zone 10
- INSTITUTIONAL - Use Zone 11
- EDUCATIONAL - Use Zone 12
- MUNICIPAL - Use Zone 13
- AGRICULTURAL - Use Zone 14
- PUBLIC GARAGE - Use Zone 15
- PUBLIC OPEN SPACE - Use Zone 16
- PRIVATE OPEN SPACE - Use Zone 17
- GOVERNMENT - Use Zone 18
- PROTECTED AREAS - Use Zone 19
- RESORT - Use Zone 20
- MINING 1 & QUARRYING - Use Zone 21
- MINING 2 - Use Zone 22
- EXISTING PUBLIC ROADS - Use Zone 23
- RAIL TRANSPORTATION SERVICES - Use Zone 24
- SPECIAL - Use Zone 25
- AERODROME - Use Zone 28
- INFORMAL ACCESS & OPEN SPACE - Use Zone 27

RECOMMENDED FOR APPROVAL

MUNICIPAL MANAGER

MARULENG 2008

APPROVED